

THOMAS KILLIGREW (1612 - 1683)

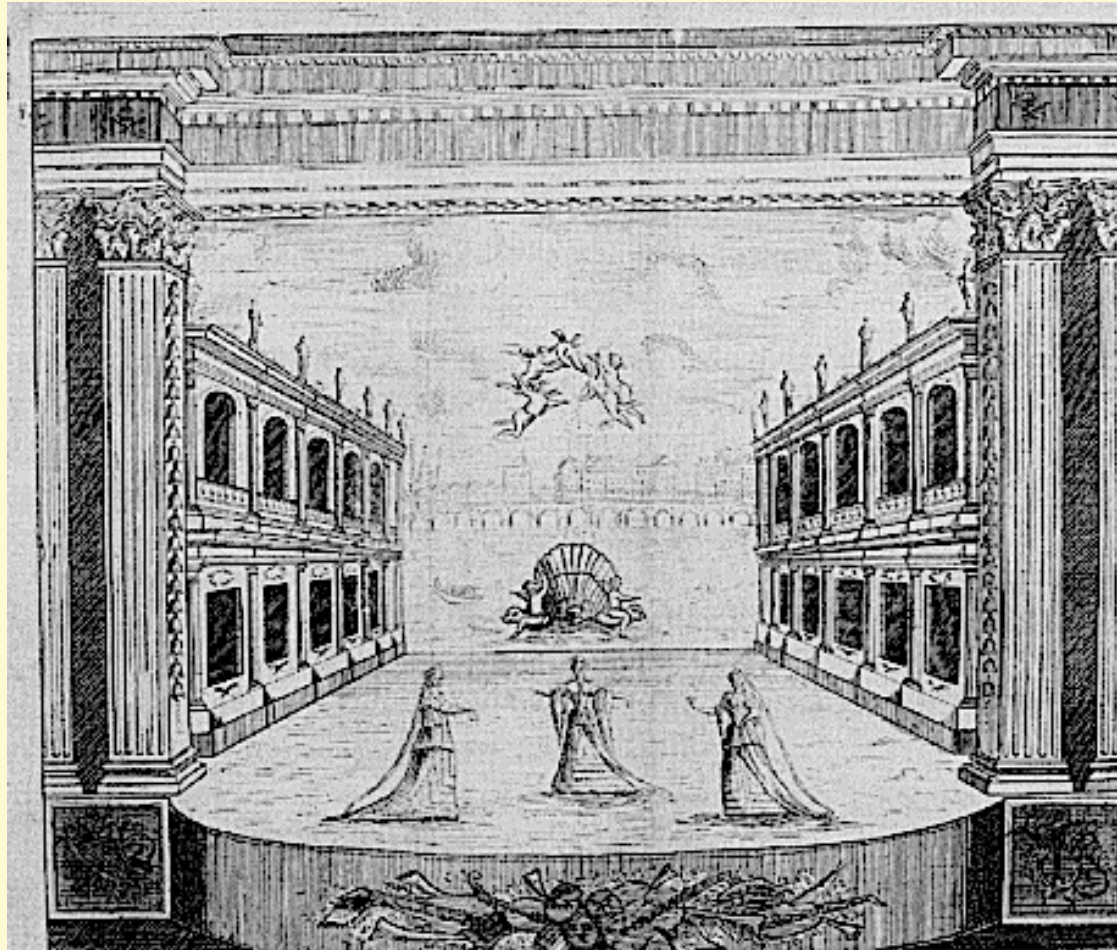

**DRURY LANE, BUILT IN 1674 BY ARCHITECT
CHRISTOPHER WREN AND OPERATED BY THOMAS
KILLIGREW AND THE KING'S COMPANY OF PERFORMERS**



DUKE'S THEATRE,
DORSET GARDEN



THEATRE ROYAL,
DRURY LANE

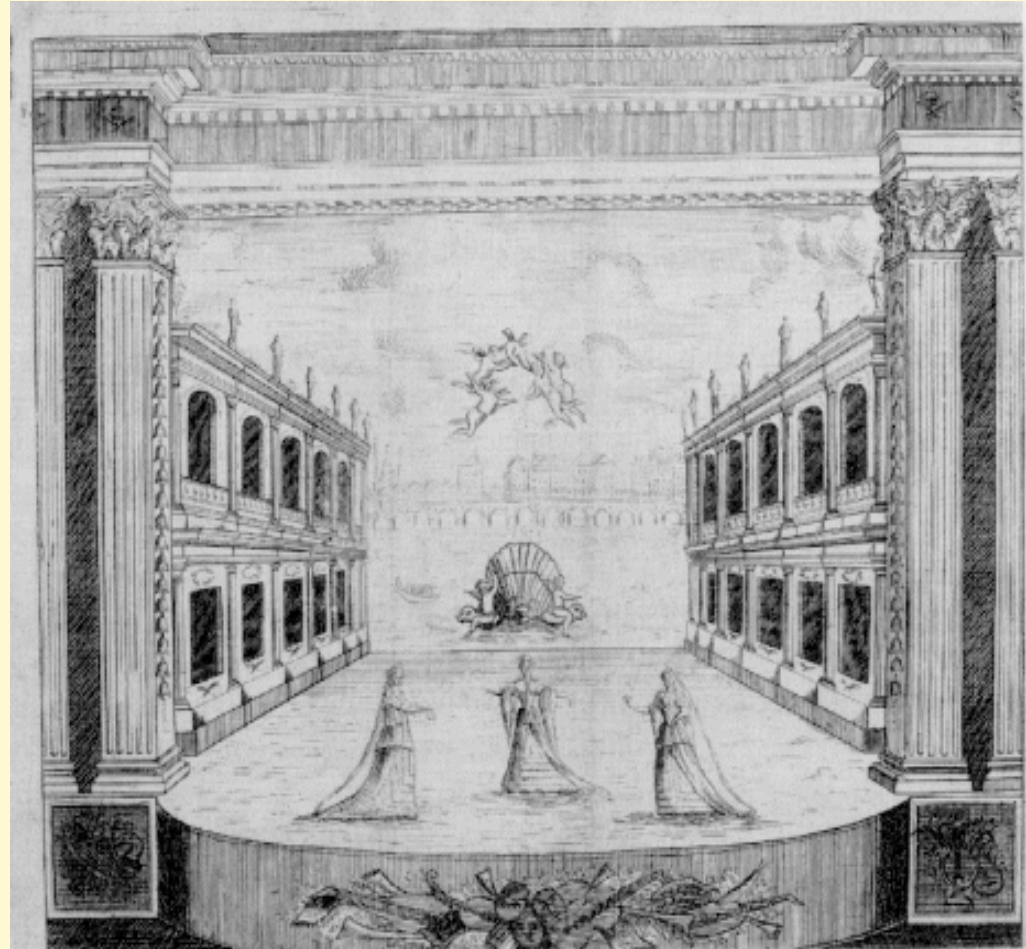

A LONGITUDINAL SECTION THROUGH A PLAYHOUSE
DRAWN BY CHRISTOPHER WREN, MAYBE THE PLAN FOR
THE SECOND THEATRE ON THE DRURY LANE SITE,
WHICH OPENED IN 1674 AFTER THE ORIGINAL THEATRE
ROYAL HAD BURNED TO THE GROUND IN 1672.

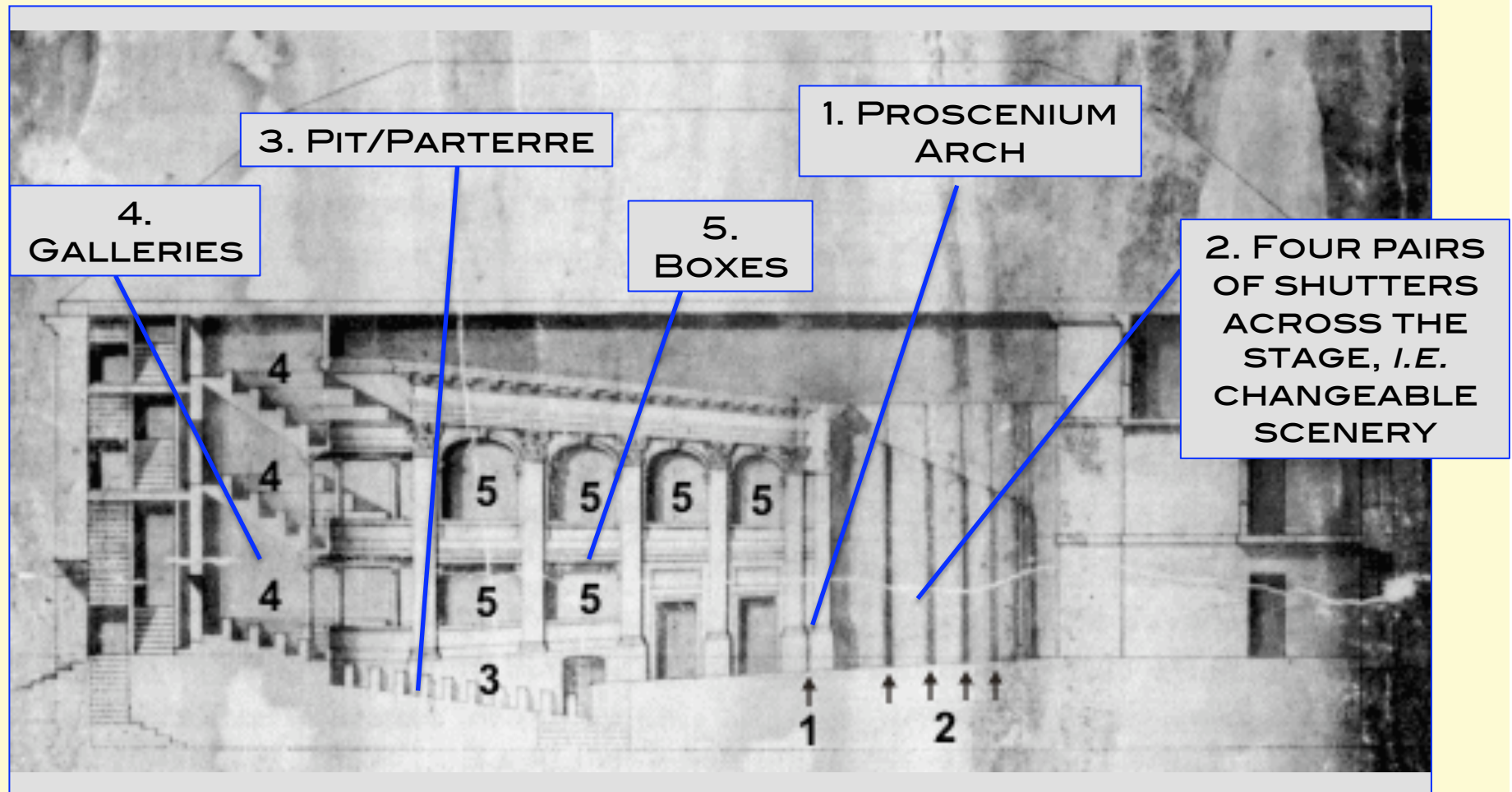

Wren's Theatre Royal, Drury Lane : 73

DOORS

MOVABLE
WINGS AND
SHUTTERS

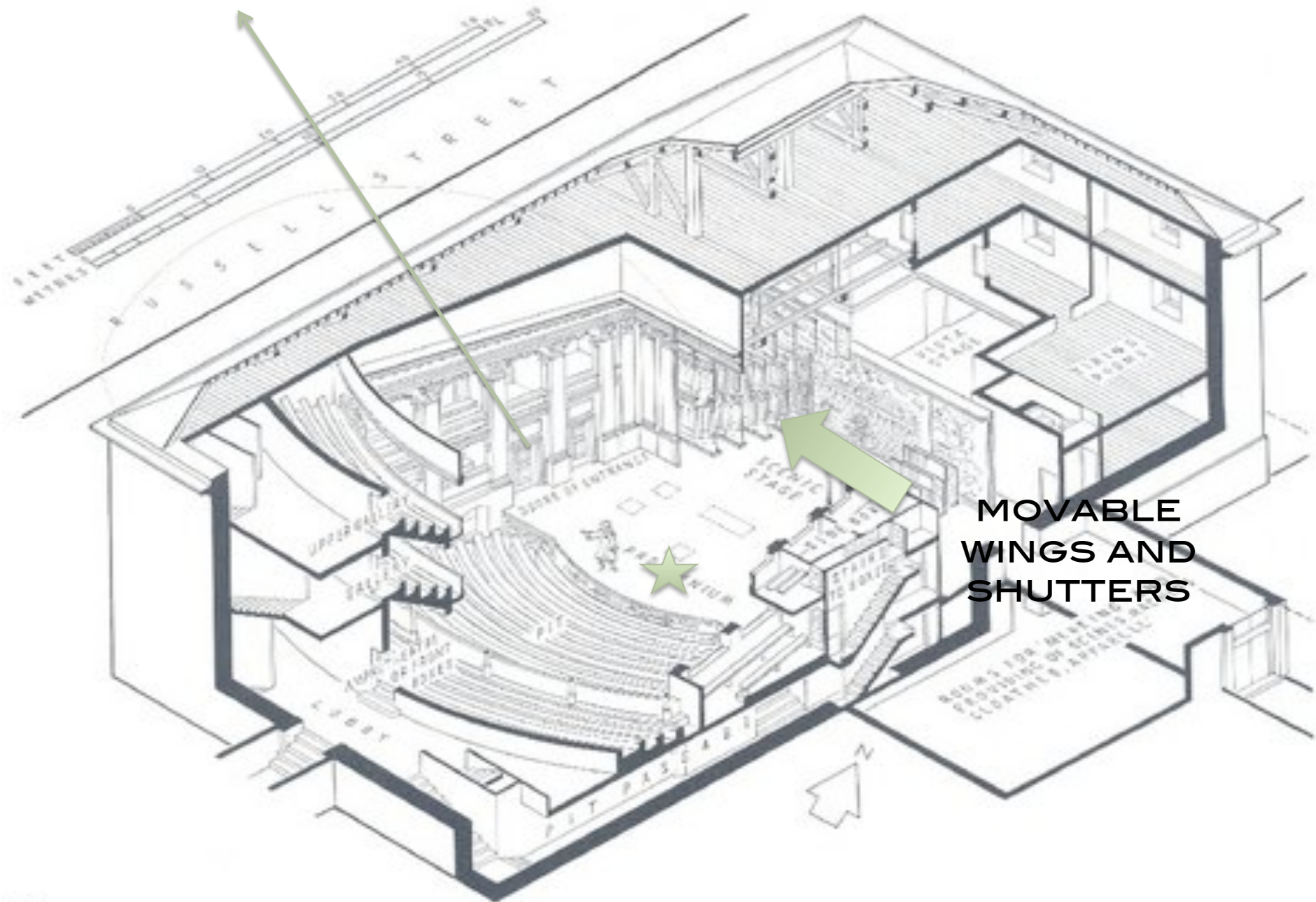

HISTORY OF THE THEATER

THE ARCHED SPECTACLE

SEE

[HTTP://WWW.YOUTUBE.COM/WATCH?V=L8VATMiyJLQ](http://www.youtube.com/watch?v=L8VATMiyJLQ)